

2. INSTALLATION INSTRUCTIONS

You can choose to put your dryer:

- on the floor.
- on a work bench.
- on a wall upside down, using the included mounting kit.



Program Inverted Mode
You can setting inverted mode follow instruction on page 6.



Normal Place Dryer

The appliance must not be installed behind a lockable door, a sliding door or a door with a hinge on the opposite side to that of the tumble dryer in such away that a full opening of the tumble dryer door is restricted.

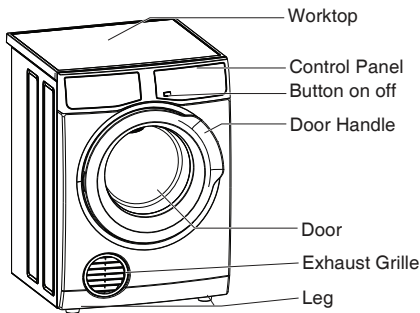

The exhaust grille has a range of positions, which allows you to select the optimum exhaust air angle. Simply hold the grille and rotate it until it hits the built-in stop.

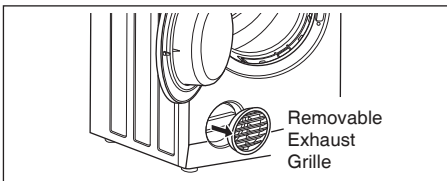

There are 2 VENTING OPTIONS

- front
- rear-using a included kit

i Important: Use only kits approved by Electrolux with your dryer.
The exhaust duct must not exceed 2 metres in length at 100mm diameter.
If connecting the dryer to a common ducting system, safety advice should be requested from the manufacturer.

If you choose to use included kit, the exhaust grille at the front of the dryer will need to be replaced with the outlet cover from the back of the dryer. Gently prise open the grille, using a thin bladed tool. Next, remove the cover from the back and clip it into the grille space at the front. The exhaust grille is not required when using a vent kit.

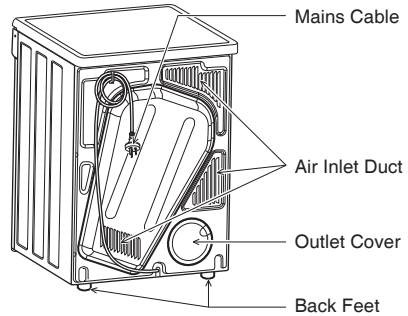

Do not install your dryer in a cupboard or small unventilated room.

You can position the vent kit at the back of the dryer to remove air upwards or sideways.

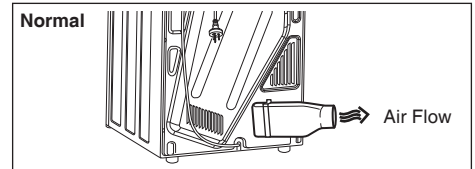
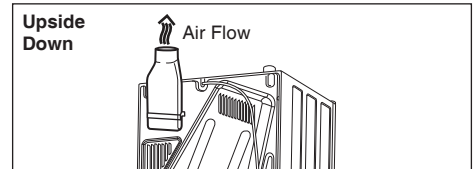

Inlet and outlet points need clear airflow to prevent overheating, so ensure there is adequate ventilation. (i.e. open window or external door.)

If a venting kit is used and the exhaust is discharged out of the room, there must be adequate ventilation to avoid the back flow of gases in to the room from appliances burning other fuels, including open fires, when operating the tumble dryer. This is not applicable where a venting hose is directed to an open window. The exhaust air must not be discharged into a flue which is used for exhausting fumes from appliances burning gas or other fuels.

Inverted Mounting Mode

To set the appliance to Inverted Mounting Mode, press and hold Program & Time buttons for 3 seconds. and waiting play Tone KeyAccept to confirm and the inverted mode will operate on display.

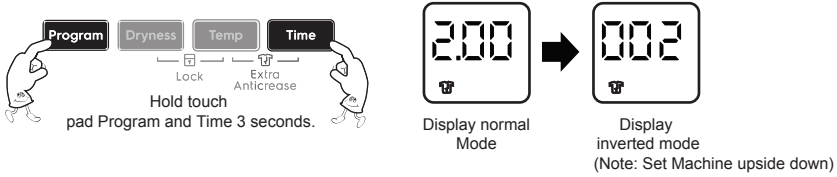

Program control for invert mounting mode

Start/Pause [Play/Pause] [Time] [Temp] [Dryness] [Program] [On/Off]

30 mins. - Airing - ☀ - [] - Time Drying

60 mins. - Low - ☀ - [] - Refresh

90 mins. - Boost - ☀ - [] - Bedding

[] - Delicates

[] - Fast 40

[] - Synthetics

[] - Mixed

[] - Cottons

Delay Start [Clock]

000

| Hr. | Min. |

Anticrease - Cooling - Drying