

User Manual

Refrigerator

EN - English



ESE6600A-AVN, ESE6600A-BVN
ESE6600A-ATH, ESE6600A-BID
ESE6600A-APH

Nomor MKG : IMKG.1332.06.2022



Electrolux

Congratulations

Congratulations and thank you for choosing our refrigerator. We are sure you will find your new refrigerator a pleasure to use. Before you use the refrigerator, we recommend that you read through the entire user manual, which provides the description of the refrigerator and its functions.

To avoid the risks that are always present when you use an electric appliance, it is important that the refrigerator is installed correctly and that you read the safety instructions carefully to avoid misuse and hazards.

We recommend that you keep this instruction booklet for future reference and pass it on to any future owners.

After unpacking the refrigerator please check if it is not damaged. If in doubt, do not use the refrigerator and contact your local Electrolux Customer Care Centre.



environmental tip

Information on disposal for users

- Most of the packing materials are recyclable. Please dispose of those materials through your local recycling depot or by placing them in appropriate collection containers.
- If you wish to discard this refrigerator, please contact your local authorities and ask for the correct method of disposal.
- Local authorities will have the latest information regarding safe disposal of the product
- Incorrect disposal may expose the user to injury from sharp objects, flammable gases or cause environmental damage.
- Refrigerant gases within the unit should only be discharged by qualified persons. A licence may be required by your local authorities to discharge or reclaim the refrigerant gases. Incorrect discharge of gases may expose the user to injury from flammable gases or cause environmental damage.

RoHS Being ensured permissible content limitation of some toxic
Compliant chemicals (RoHS compliant)

Contents

Important safety instructions	3
Installing your new refrigerator	4
Refrigerator operation	5
Refrigerator features	6
Using the control panel	7
Features of your refrigerator	8
Cleaning your refrigerator	9
Energy consumption	9
Food storage guide	10
Troubleshooting	11

Conditions of use

This appliance is designed and intended to be used in household and similar applications such as;

- staff kitchen areas in shops, offices and other working environments;
- farm houses and by clients in hotels, motels and other residential type environments;
- bed and breakfast type environments;
- catering and similar non-retail applications.



warning

Warning



Warning: Risk of fire / flammable materials

This appliance contains flammable R600a refrigerant. Avoid safety hazards by carefully installing, handling, servicing and disposing of this appliance.

- Ensure that the tubing of the refrigerant circuit is not damaged during transportation and installation.
- Leaking refrigerant may cause eye injuries or ignite.
- The room for installing appliance must be at least 1m³ per 8g of refrigerant. The amount of refrigerant in the appliance can be found on the rating plate inside the refrigerator appliance.
- If you are unsure of the refrigerant check the rating plate inside the refrigerator compartment.
- It is hazardous for anyone other than an Authorized Service Person to service this appliance.
- Keep ventilation openings in the appliance enclosure or in the built-in structure, clear of obstruction.

Important safety instructions

Please read the user manual carefully and store in a handy place for later reference.

The symbols you will see in this booklet have these meanings:



warning

This symbol indicates information concerning your personal safety



caution

This symbol indicates information on how to avoid damaging the appliance



tips and information

This symbol indicates tips and information about use of the appliance



environmental tip

This symbol indicates tips and information about economical and ecological use of the appliance

Meanings of symbols used in this manual are shown below:



This symbol indicates never to do this



This symbol indicates always do this



warning

- If pressurised aerosol containers bear the word 'flammable' and/or a small flame symbol, do not store them inside any refrigerator or freezer. If you do so, you may cause an explosion.
- This appliance is not intended for use by persons (including children) with reduced physical, sensory or mental capabilities, or lack of experience and knowledge, unless they have been given supervision or instruction concerning use of the appliance by a person responsible for their safety.
- Children should be supervised to ensure that they do not play with the appliance.
- When you dispose of your old refrigerators and freezers, remove any doors. Children can suffocate if they get trapped inside.
- This appliance contains insulation formed with flammable blowing gases. Avoid safety hazards by carefully disposing of this appliance.



Warning: Risk of fire / flammable materials



warning

- ✓ The appliance must be plugged into its own dedicated 220-240V, 50/60Hz AC electrical outlet.
- ✓ Ensure that the electric outlet is properly earthed to ground. Consult a qualified electrician if you are unsure.
- ✓ The plug must be accessible when the appliance is in position.
- ⊘ Do not use an extension cord or adapter plug.
- ✓ If the power cord is damaged, it must be replaced by the manufacturer, its service agent or similarly qualified persons to avoid a hazard.
- ✓ Unplug the appliance before cleaning and before changing the light bulb to avoid electric shock.
- ⊘ Never unplug the appliance by pulling on the power cord. Always grip the plug firmly, and pull straight out of the receptacle to prevent damaging the power cord.
- ✓ Choose a location that is not too cold – the temperature should be above 10°C.
- ✓ Put the appliance in a dry place, avoiding areas of high moisture or humidity.
- ⊘ Don't put the appliance in frosty or unprotected areas, for example in a garage or on a verandah.
- ⊘ Don't put the appliance in direct sunlight
- ⊘ Don't put the appliance near stoves, fires or heaters.
- ⊘ Do not use mechanical devices or other means to accelerate the defrosting process, other than those recommended by the manufacturer.
- ⊘ Do not damage the refrigerant circuit.
- ⊘ Do not use electrical appliances inside the food storage compartments of the appliance, unless they are of the type recommended by the manufacturer.
- ⊘ Do not store explosive substances such as aerosol cans with a flammable propellant in this appliance.

When correctly installed, your appliance should:

- have adequate clearance to the back and sides for air circulation (refer to page 4).
- be aligned to the surrounding cupboards.
- have doors that will self-close from a partially open position.



warning

- Have the stability foot in place (see diagram on page 4) to prevent the appliance falling forward when a door with heavy food load is opened.

Installing your new refrigerator

Clearance around your refrigerator

Your Side by Side Refrigerator can be installed between cupboards or fixtures but you must consider the following spaces around the cabinet:

1. Allow a minimum of 10mm clearance on both sides.
2. Allow 30mm clearance at the back of the refrigerator.
3. Allow 10mm clearance above the hinge covers.

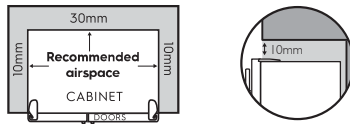

4. Allow a 349 or 427mm clearance on the hinge side of the doors, if you place the refrigerator next to the wall. This will make cleaning easier.

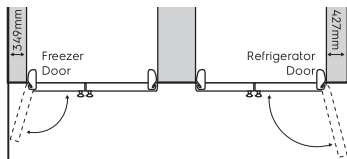

5. Make sure that cupboards or fixtures do not stick out further than the refrigerator cabinet.

Note: Refrigerator doors on all models are designed to sit proud of cabinetry (not flush).

Installing your refrigerator

The appliance should arrive with the stability foot wound fully up so it will not interfere with the operation of the rollers (see diagram in Step 3 below).



The rollers are designed for forward or backward movement only. They are not castors. Moving the refrigerator sideways may damage your floor and the rollers.

1. Roll the refrigerator into its final position.
2. The top of the refrigerator should be tilted back by approximately 20mm. This will allow the doors to self-close providing a consistent door seal and stability when the doors are open.
3. When you have the appliance in its final position, it needs to be stabilized. Wind the stability foot down to the floor until it just makes contact with the floor. Whenever you need to move the appliance, be sure to wind the foot back up so that the appliance can roll freely and be sure to reset it when reinstalling.
(The wrench opening size 30mm)

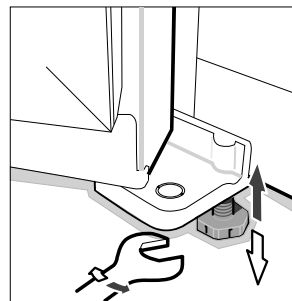

4. Check the alignment of the refrigerator to the surrounding cupboards. The top of the refrigerator should be on the same level from side to side (see diagram below). If you need to adjust the level, use the adjustable rollers as discussed in Step 3.

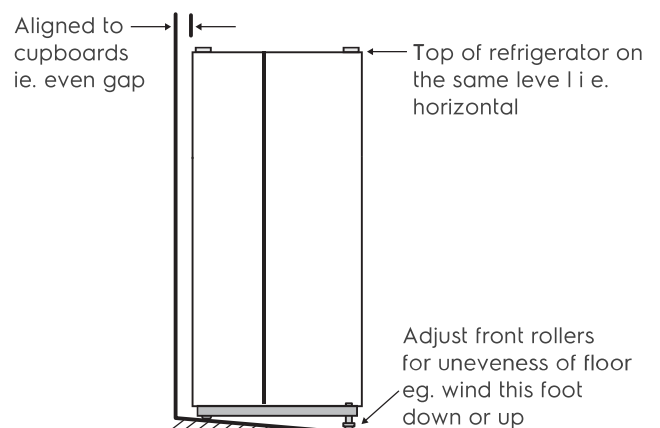

5. If the refrigerator rocks from one corner to the opposite rear corner, this means that the floor is uneven; you will need to put some packing under one of the rear rollers. You could use thin pieces of solid material, such as thin board, vinyl floor tiles or laminate. Place the packing so that it will sit under one of the rear rollers when the refrigerator is rolled into position.
6. You may now need to fine-tune the installation by repeating Steps 3, 4 and 5.
7. Whenever you need to move the refrigerator, be sure to wind the foot back up so that the refrigerator can roll freely.
8. Clean your refrigerator thoroughly following the instructions on page 9 and wipe off any dust that was accumulated during shipping.
9. Leave standing in stable upright position for 2-3 hours prior to turn "on".
10. Plug the refrigerator into the power point. Don't use a double adaptor. If you need to roll the refrigerator out to get at the power point, remember to raise the stability foot before you do so.
11. We recommend that you let your refrigerator run for two to three hours before you put any food in it. It will allow you to check that it is operating properly.

Your new refrigerator has been supplied with protective plastic film on the doors and cabinet, you can choose to remove this film as needed.

Congratulations! You have successfully installed your new refrigerator.



caution

Keep ventilation openings, in the appliance enclosure or in the built-in structure clear of obstruction.

Refrigerator Operation

The refrigerator transfers heat from food placed inside the appliance to the outside air.

This process makes the rear, the sides and the area adjacent to the doors, particularly at initial start up, feel warm to hot, this is normal.

There is a cooling coil located behind the rear wall of the cabinet. This coil cools and removes moisture from the air. A fan then circulates cold, dry air throughout the cabinet.

This air circulation means that food are refrigerated far more quickly than in refrigerators where the air remains relatively static.

Avoid placing food against air outlets as this will affect air circulation.

A light frosting will occasionally occur on the cold interior of the freezer when the door is opened frequently. This is normal and will disappear after a few days in most climates.

Make sure you fully close the freezer door after you load or remove food. If the door is left partly open, a heavy frost will coat the inside of the freezer. If a frost develops, remove it. Ensure to properly close the door, so the frost will not reoccur.

Your new energy efficient appliance uses a high-speed compressor and other energy efficient components that may produce different noises to your old appliance.

These sounds are normal and includes:

- compressor running noise.
- air movement noise from the small fan motor.
- occasional gurgling, similar to water boiling.
- a popping noise, heard during automatic defrosting.
- a clicking noise, just prior to the compressor starting up.

These noises are normal and will not cause the unit to alarm.

Temperature Control

The factory default settings;

Refrigerator = 5°C Freezer = -19°C

If you want to change the temperature, follow the instructions in the section about the user interface for your model. Ensure that you make only small adjustments and wait 24 hours to see if it's correct to your liking.

Note: When you set a temperature, you set an average temperature for the whole refrigerator cabinet.

Checking the softness of ice cream is a good indication that your freezer is the right period. While checking the temperature of water kept in the refrigerator is a good way of checking the temperature of the food compartment.

Temperature inside each compartment may vary, depending on how much food you store and where you place it.

High or low room temperature may also affect the actual temperature inside the refrigerator.



caution

This appliance can be used by children aged from 8 years and above and persons with reduced physical, sensory or mental capabilities or lack of experience and knowledge if they have been given supervision or instruction concerning use of the appliance in a safe way and understand the hazards involved. Children shall not play with the appliance. Cleaning and user maintenance shall not be made by children without supervision.

Refrigerator features

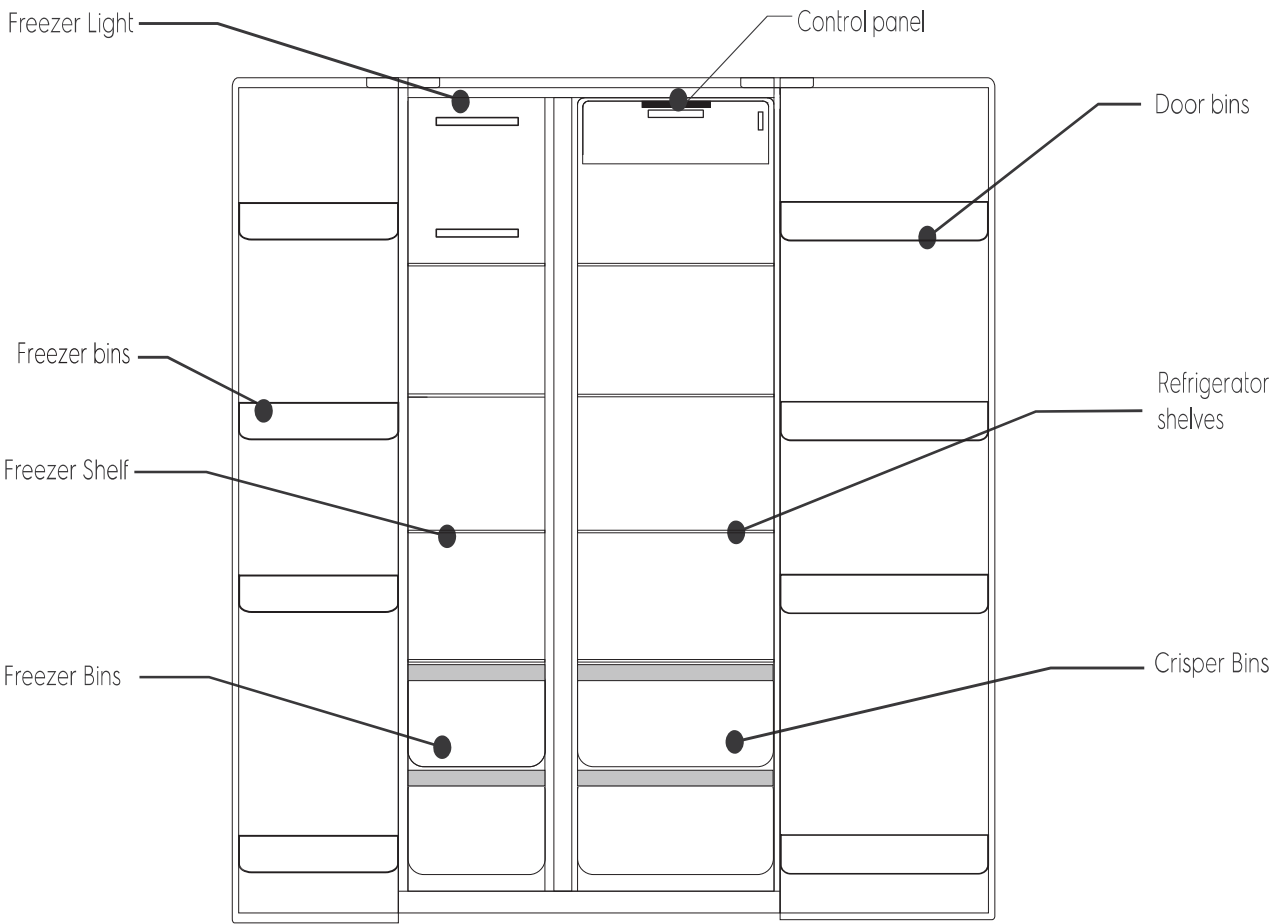

Control Panel
The control panel is located on the fridge door.

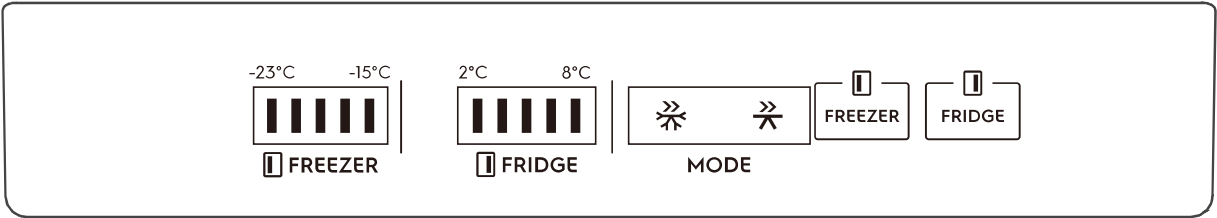

Note: Product illustrations demonstrate various features but may not be completely in line with current products.

Using the control panel

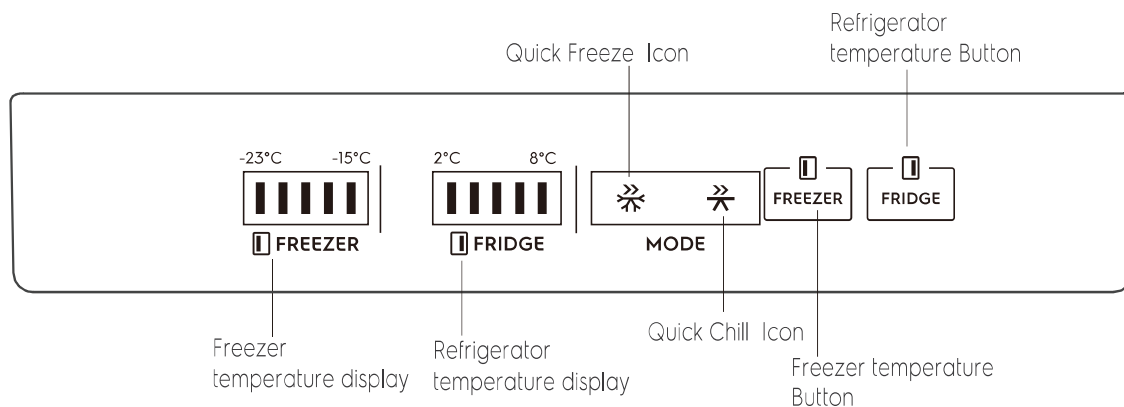

Function setting of the LED display

Note: the display will turn off after 20 seconds of inactivity, while the display will wake up if the button is touched again.

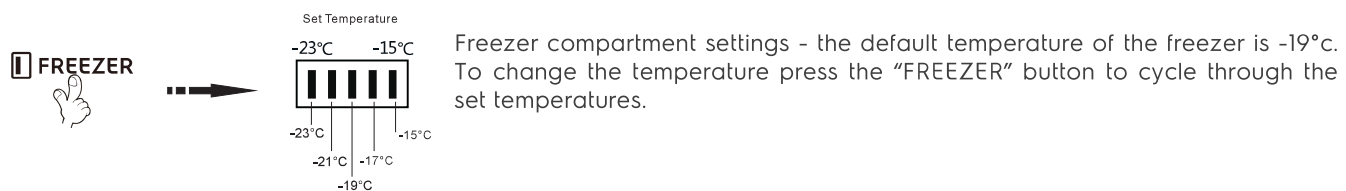

- Quick Freeze mode - When the freezer display area reaches the minimum temperature, press the "FREEZER" button again to enter the super freezer mode.

When the super freezer mode is selected, the compressor will operate continuously to freeze foods faster, and keep them fresh. The super freezer mode will automatically turn off either after 24h of operation, or when the freezer reaches -28°C. The super freezer icon will turn off, and the freezer will continue to operate at the normal set temperature.

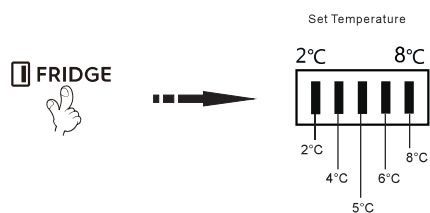

Fridge compartment settings - The default temperature of the refrigerator is 5°C. To change the temperature press the "FRIDGE" button to cycle through the set temperatures.



- Quick Chill mode - When the fridge display area reaches the minimum temperature, press the "FRIDGE" button again to enter the super fridge mode.

When the super fridge mode is selected, the fridge compartment reaches the set temperature in the shortest period, in order to keep the food as fresh as possible. Under this mode, the set temperature of the fridge compartment locks on 2°C. The program runs 150mins maximally then exits automatically, the super fridge icon goes out, which represents the super fridge function is disabled, the set temperature returns to the last one before the super fridge mode operates.

Function setting of the LED display

Long press "FRIDGE" button for 5 seconds to set fridge compartment on/off, when fridge compartment is switched off, the fridge temperature digital display will go off; under the fridge compartment switched off state, long press "FRIDGE" button for 5 seconds to restart fridge function.

Features of your refrigerator

This section tells you how to make the most of the many useful features and how to clean them.

Door storage bins

Disassembly: Hold both sides of the bottle shelf with both hands. Push it from the side without the boss and push it inward as the direction of the arrow. When pushing hard, please note that the buckle on the edge of bottle shelf is separated from the groove of the liner. Then bottle shelf can be removed.

Installation : Hold both sides of the bottle shelf with both hands. Install the buckle of the boss side at first. Then push the other side inward slightly, the buckle can be fixed.

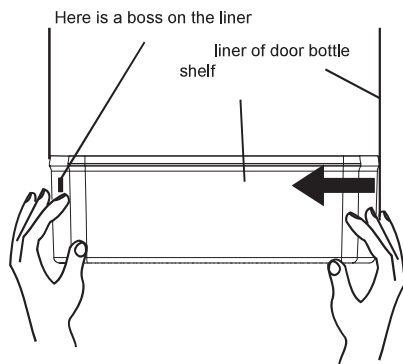

Crisper Bin

You can use the crisper bin to store vegetables, fruit or smallgoods. To remove, pull it forward then up and out.

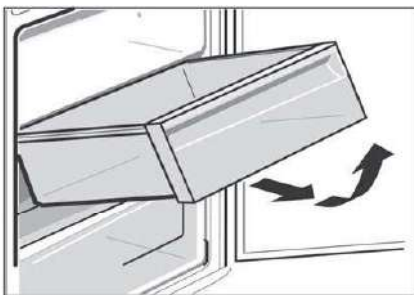

Glass Shelves

When removing the glass shelf, please press the movable pin under the shelf with both hands and push inward at the same time. Then the glass shelf will be removed.

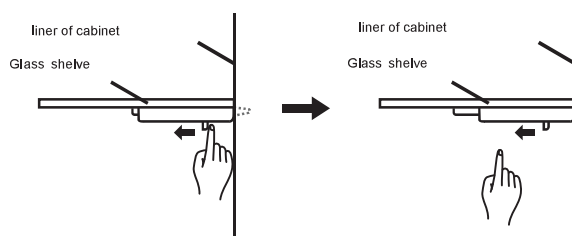

LED lighting

Your refrigerator is fitted with long life LED lighting.

In the unlikely event the LED lights should fail, then the LED lights should be serviced by the manufacturer, its service agent or similarly qualified technician. Refer to the warranty page for contact details.

Cleaning your refrigerator



warning

Before cleaning: Turn appliance off at the power point, then remove power cord from socket. This will make sure there is no chance of getting an electric shock.

Doors and exterior

You should only clean the doors with lukewarm soapy water and a soft cloth. Rinse with clean water and then wipe the surface with clean water and a soft clean cloth to remove soap residue.



caution

Do not use stainless steel cleaners, abrasive pads or other cleaners as they are likely to scratch the surface. Damage to this product after delivery is not covered by your warranty.

Interior

You should clean the appliance interior regularly. It will be easiest to clean when the food supply is low. Wash the interior with a soft cloth and use an unscented mild soap with lukewarm water. Thoroughly dry all surfaces and removable parts. Avoid getting water on appliance controls. If you have taken out any removable parts, replace them and switch the power on before re-stocking the appliance with food. Naturally, you should keep the interior of your appliance hygienic by promptly and thoroughly wiping up any food spills.

Door seals

Take care with Ensure to keep door seals clean. Sticky food and drink can cause seals to stick to the cabinet and tear when you open the door.

Wash seal with a mild detergent and warm water. Rinse thoroughly and dry.



warning

Never use hot water, solvents, commercial kitchen cleaners, aerosol cleaners, metal polishes, caustic or abrasive cleaners, or scourers to clean this appliance, as they will damage it. Many commercially available cleaning products and detergents contain solvents that will damage your refrigerator. When cleaning, use only a soft cloth with an unscented mild soap and lukewarm water.

Energy consumption

The following guide will help you reduce the running cost of your new refrigerator. This will save you money and help conserve our valuable energy resources.

1. Do not block air vents. Doing so may cause the refrigerator to run longer and use more energy.
2. Do not set your freezer temperature too low. After 24 hours, ice cream should be firm but able to be scooped out with a spoon without bending the handle. If ice cream is firmer than this (or too soft), adjust the freezer temperature controls (see 'Set Temperature', page 7).
3. Ensure that the refrigerator doors seal properly as you close them.
4. Before you open the refrigerator doors, decide what you want to put in or take out. This will minimize the time you have the doors open.
5. It is best to have the refrigerator in a place that is out of direct sunlight and away from heating appliances of any kind. For example, do not place the refrigerator next to a cooker, stove or dishwasher.
6. Allow hot foods to cool to room temperature before you put them in your freezer.
7. Thaw frozen foods in the refrigerator section.
8. If you keep the freezer compartment filled to capacity, your food mass will help maintain the freezer temperature when you open the door.

Turning off the refrigerator

If you are leaving for a short holiday, there is no need to turn off your refrigerator.

If you are going on a long holiday and want to turn the refrigerator off, follow the steps below.

1. Take all the food out of the refrigerator and freezer compartments.
2. Switch off the refrigerator and remove the electric cord from the power point.
3. Clean the inside.
4. Leave the doors open. This prevents bacteria from growing and causing smells in the refrigerator.

Power failure

If there is a power failure in your area, keep the door to the freezer closed. Most foods in your freezer will stay frozen for 24 hours.

Food storage guide

Category	Product	Refrigerator	Freezer	Storage tips
Meat	Sausages and mince	1-2 Days	2-3 Months	Keep cold meat at the back of the refrigerator where it is coldest.
	Chops and steak	3-4 Days	4-6 Months	
	Cold meats	3-5 Days	4-6 Months	Plastic can cause meat to sweat if stored in refrigerator for more than a day.
	Roasts	3-5 Days	12 Months	Roast can take up to 48 hours to defrost properly, transfer frozen roast to the refrigerator 2 days before use.
Poultry	Chicken	1-2 Days	2 Months	If poultry takes on a smell or colour you are unsure about it is best to throw it out.
	Roast Chicken	3-5 Days	12 Months	
	Eggs	6 Weeks	Not Suitable	Whole eggs are not suitable for freezing, slightly beaten eggs may be frozen for four months.
Seafood	Whole fish and fillets	2-3 Days	2 Months	Store in an airtight container or foil.
	Lobster and crabs	1-2 Days	2 Months	
	Prawns	1-2 Days	2 Months	Never freeze prawns in salty water as this will dehydrate the flesh.
Dairy	Milk	Until Expiry Date	Not Suitable	If dairy takes on a smell or colour and you are unsure about it, it is best to throw it out.
	Yoghurt	7-10 Days	Not Suitable	
	Hard Cheeses	2 Weeks - 2 Months	2 Months (Grated)	Depending on the variety hard cheese can last from 2 weeks to 2 months.
	Soft Cheeses	1-2 Weeks	Not Suitable	
	Butter	8 Weeks	12 Months	
Fruit & Vegetables	Every fruit and vegetable has a different shelf life. Some stay fresh for a couple of days e.g beans, others can last for a couple of months e.g. onions.		8-12 Months	Keep vegetables in the crisper and away from the air vents to avoid freezing.
			When freezing chop and blanch in small portions.	Don't wash fruit and vegetables before storing them in the refrigerator as this can make them susceptible to rotting.
Left overs	Homemade meals	3-4 Days	2-6 Months	Store in sealed container.
				Freeze meals in small portion sizes to limit wastage.



IMPORTANT

Please note, use this information as a guide only, actual storage times will vary depending on how you use your refrigerator, climatic conditions and the freshness of the food.

Troubleshooting

If you think something may be wrong with your refrigerator, you can carry out some easy checks before calling for service. You may locate the problem, sparing yourself from inconvenience and saving time and money.

Problem	Solution
When your appliance is not operating	• Make sure that the power cord is plugged into the power outlet properly and that the outlet is switched 'ON'.
	• Try running another appliance from the power outlet. If no power is coming from the outlet you may have blown a fuse or tripped a circuit of your household power supply.
	• Try adjusting the temperature control to a slightly "colder" position.
	• It is normal for the freezer fan NOT to operate during the automatic defrost cycle, or for a short time after the appliance is switched on.
When there is refrigerator/freezer noise	Modern refrigerators/freezers with increased storage capacity use high speed compressors. These can provide a seemingly high level of sound which is quite normal. Normal operational sounds include:
	• Occasional gurgling, similar to water boiling.
	• Air flow noise (air circulates because of a small fan).
	• A popping noise heard during automatic defrost.
If there are odours inside the appliance	Other strange sounds may mean that you need to check and take action. For example, noises may mean that:
	• The cabinet is not level.
	• The floor is uneven or weak.
	• Bottles are badly placed and rattling.
When the motor seems to run more than expected	• There are vibrations from an object on top of or behind or beside the refrigerator.
	• The back of the refrigerator cabinet is touching the wall.
	Remember it is quite normal for noise to seem louder when the refrigerator starts operating, or during quieter periods such as night time.
If the temperature in the refrigerator is too cold	• The interior may need cleaning.
	• Some food produce odours.
	• Some containers and wrapping can cause odours.
	• Ask yourself if the odour started about the same time you started storing something unusual.
If heavy frosting occurs in the freezer	Your new appliance provides you with large capacities in both the refrigerator section and the separate freezer. It is normal for the motor to operate frequently. However, to keep operation to a minimum, check the following:
	• Are doors kept open too long or too often?
	• Are controls set too cold? refer to "Using the control panel" for how to adjust.
	• Have large amounts of warm food just recently been stored? Summer, festive seasons and holidays usually mean a lot more work for your appliance.
If water drips on the floor	• If the day is hot or the room is very warm, the appliance will need to run more than normal.
	• The appliance will run more than normal just after you install it or when it has been turned off for a long time.
	• Refer to "Using the control panel" for how to adjust.
	• Increase the temperature to avoid high energy consumption.
Freezer Door opens after closing fridge door	Make sure you fully close the freezer and fridge doors. If the doors are left partly open a heavy frost will coat the inside of the freezer. If a frost develops, remove it. Make sure properly close the doors and the frost will not reoccur.
	The defrost water tray, (located at the back of the cabinet), may not be properly positioned, or the drain tube may not be properly positioned to direct water into this tray. You may need to pull the refrigerator away from the wall to check the tray and tube.
	It is normal for the freezer door to momentarily open and re-close when the food compartment door is closed. If the freezer door stays open, it indicates that the refrigerator cabinet needs to be tilted backwards a little further. If you call a service person to solve this problem, you will be charged for the cost of a service call, as this is not a warranty fault.
When temperature is hot/warm on the outside and rear side of the Fridge	In normal operation, the fridge transfers heat from inside to outside of the cabinet. It is normal for the side and rear of the fridge to feel warm/hot while operating. This will be more noticeable during start up and hot ambient conditions.

If you have a problem, and the problem persists after you have made the checks mentioned above, contact your nearest Electrolux approved Service Centre or the dealer you bought the refrigerator from. Be ready to quote the model number, 9-digit PNC and 8-digit serial number, which is stated on the label inside the refrigerator compartment



CONTACT DETAILS ELECTROLUX CUSTOMER CARE

Thailand

Call Center Tel: (+66 2) 725 9000 Electrolux
Thailand Co., Ltd
Electrolux Building
14th Floor 1910 New Petchburi Road Bangkokpi,
Huay Kwang, Bangkok 10310
Office Tel: (+66 2) 725 9100
Office Fax: (+66 2) 725 9299
Email: customercare@electrolux.co.th

Indonesia

Layanan langsung konsumen: 08041119999
PT. Electrolux Indonesia
Electrolux Building
Jl. Abdul Muis No.34, Petojo Selatan, Gambir
Jakarta Pusat 10160
Email: CustomerCareID@electrolux.com.
SMS & WA : 0812.8088.8863

Vietnam

Domestic Toll Free: 1800-58-88-99
Tel: (+84 8)3910 5465
Electrolux Vietnam Ltd
Floor 9th, A&B Tower
76 Le Lai Street - Ben Thanh Ward - District 1
Ho Chi Minh City
Vietnam
Office Tel: (+84 8) 3910 5465
Office Fax: (+84 8) 3910 5470
Email: vnccare@electrolux.co.vn

Malaysia

Domestic Toll Free: 1300-88-11-22
Electrolux Home Appliances Sdn. Bhd
7th Floor, Tower 2, Jaya 33, No. 3 Jalan Semangat, Seksyen
13, 4610 Petaling Jaya, Selangor
Office Tel: (+60 3) 7843 5999
Office Fax: (+60 3) 7955 5511
Customer Care Center: Lot C6, No. 28, Jalan 15/22, Taman
Perindustrian Tiong Nam, 40200 Shah Alam, Selangor.
Consumer Care Hotline: (+60 3) 5525 0800
Fax: (+60 3) 5524 2521

Philippines

Domestic Toll Free: 1-800-10-845-care 2273
Customer Care Hotline: (+63 2) 845 care 2273
Electrolux Phils Inc
25th Floor, Equitable Bank Tower 8751
Paseo De Roxas, Makati City
1226 Philippines
Office Tel: (+63 2) 845 4510
Office Fax: (+63 2) 845 4548
Email: wecare@electrolux.com

Singapore

CONSUMER CARE HOTLINE : (+65) 67273699
Electrolux S.E.A. Pte Ltd.
1 Fusionopolis Place, West Lobby #07-10 Galaxis,
Singapore 138522.
Office Fax: (+65) 67273611
Email : customer-care.sin@electrolux.com

Hongkong

DCH ELECTRICAL APPLIANCES SERVICE CENTRE
4/F, DCH BUILDING, 20 KAI CHEUNG ROAD,
KOWLOON BAY, HONG KONG
SERVICE HOTLINE: (+852) 3193 9888
EMAIL: customercare@dch.com.hk
WEBSITE: www.electrolux.com.hk